

# Plug-in 70mm PHC & MIC Control Plate Assembly Parts List

PRODUCT INFORMATION BULLETIN #3857

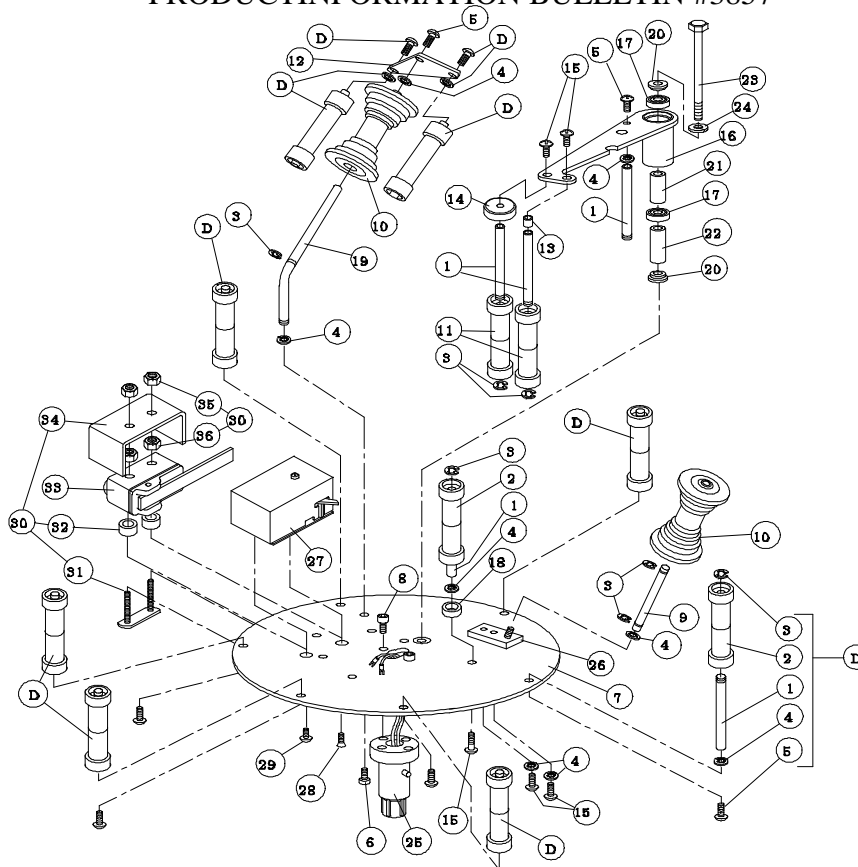

- |   |   |
|---|---|
| 3046 Control Plate Assy., Plug-In, 70mm MIC Complete  | 20) 2380 Control Plate Sensor Arm Washer  |
| 3071 Control Plate Assy., Plug-In, 70mm PHC Complete  | 21) 2379 Control Plate Sensor Arm Spacer  |
| D) 2876 Spool & Shaft Assy., 70mm (includes 1-5)      | 22) 1742 Control Plate Arm Hub Standoff, 70mm                                     |
| 1) 1431 Spool Shaft, 70mm                             | 23) 3009 HHCS, 1/4-28 x 3 3/4"  |
| 2) 1491 Spool Assembly, 70mm                          | 24) 1079 Lockwasher, 1/4" Split Ring  |
| 3) 1050 E-Ring, 5/16"                                 | 25) 3443 Control Plate, Plug-In Adapter 70mm (Includes item 8)                    |
| 4) 1078 Lockwasher, #10, Internal Tooth               | 26) 4323 Control Plate Angle Block 70mm<br><b>PHC Control Plate Only</b>          |
| 5) 1071 Screw PTH, 10-32 x 3/8"                       | 27) 2430 Phase Control Assy., w/mounting package (Includes 28 & 29)               |
| 6) 1592 SHCS, 10-32 x 1/2"                            | 28) 1070 Screw, PFH, 8-32 x 3/8"  |
| 7) 2210 Control Plate & Nut Sub Assy. 70mm            | 29) 1069 Screw, PTH, 8-32 x 3/8"  |
| 8) 1064 SHCS, 8-32 x 3/8"                             | <b>MIC Control Plate Only</b>   |
| 9) 1654 Pulley Shaft-Castor, 5/16" Dia. 70mm          | 30) 3610 Control Plate Micro Switch Mount Hardware (Includes 31, 32, 34, 35 & 36) |
| 10) 1715 Pulley Assy. 5/16" ID, 70mm                  | 31) 1469 Switch Adjusting Plate Assy.   |
| 11) 3067 Sensor Arm Spool Assy. 70mm                  | 32) 1240 Spacer, 5/16" x 13/64" x 1/4"  |
| 12) 1436 Control Plate Keeper Tab, 70mm               | 33) 2536 Micro Switch-Flat Blade-HD   |
| 13) 1153 Control Plate Arm Spool Spacer Float         | 34) 1595 Micro Switch Cover   |
| 14) 2006 Control Plate Arm Film Spacer                | 35) 1084 Locknut, Nylon Insert, 6-32  |
| 15) 1072 Screw, PTH, 10-32 x 1/2"                     | 36) 1083 Hex Nut, 6-32  |
| 16) 1691 Control Plate Sensor Arm & Hub               |   |
| 17) 2407 Bearing, 5/8 OD x 1/4 ID                     |   |
| 18) 4301 Control Plate Feed Exit Spool Spacer, 70mm   |   |
| 19) 1658 Control Plate Exit Shaft #3, 5/16" Dia. 70mm |   |